

## AT3

## TECHNICAL CHARACTERISTICS OF THE TOOLHOLDERS

## TECHNISCHE EIGENSCHAFTEN DER AUFNAHMEN

## MANUFACTURED FROM FORGED PARTS

## MATERIAL:

- Alloyed carburized steel at chrome-manganese 1.7131 (16MnCr5).

## EXECUTION:

- Carburized, hardness.  
- Surface hardness HRC 58±2 (670±40 HV30)  
- Depth minimum 0,5 mm.  
- Tensile strength in core minimum 800 N/mm<sup>2</sup> after carburizing.

## ACCURACY:

- Taper according to DIN 254  
- Taper angle:  
tolerance AT 3 DIN 7178 part 1 and DIN 2080 part 1.  
- Other tolerances according to DIN 7160 and 7168.  
- Taper surface roughness  $R_z < 0,001$  mm.

K	AT 3 mm
ISO 30	0,002
ISO 40	0,003
ISO 45	0,003
ISO 50	0,004
ISO 60	0,005

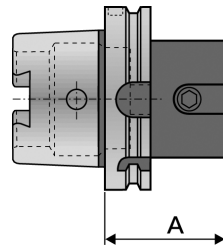

## HERGESTELLT AUS GESCHMIEDETEN TEILEN

## MATERIAL:

- Legierter Aufgekohlter Stahl mit Chrom-Mangan 1.7131 (16MnCr5).

## KONSTRUKTIONS DATEN:

- Aufgekühlt, gehärtet und angelassen.  
- Oberflächenhärte HRC 58±2 (670±40 HV30).  
- Aufgekühlt auf minimum 0,5 mm Tiefe.  
- Zugfestigkeit im Kern minimum 800 N/mm<sup>2</sup> nach der Aufkohlung.

## GENAUIGKEIT:

- Dorn nach DIN 254.  
- Kegelwinkel:  
Toleranz AT 3 DIN 7178 Teil 1 und DIN 2080 Teil 1.  
- Andere Toleranzen entsprechend DIN 7160 und 7168.  
- Rauigkeit der Oberfläche  $R_z < 0,001$  mm.

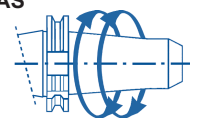
PORTAHERRAMIENTAS  
PRE-EQUILIBRADOSPREBALANCED  
TOOLHOLDERS

ISO 40 ▶ 8000 rpm ISO 50 ▶ 8000 rpm

## TOLERANCE AT :

- Indicates the tolerance of size D surface between the real and the theoretical value of the taper conicity.  
- This value of surface D must always be less (negative), never more (positive) in order to GUARANTEE a good toolholder fixation at the bigger taper diameter.

## TOLERANZ AT :

- Zeigt die Toleranz auf der Messebene D zwischen dem tatsächlichen Wert der Kegelkonizität und dem theoretischen Wert.  
- Dieser Wert auf der Messebene D sollte immer minus (negativ) sein, nie plus (positiv), um für einen guten Halt des Futter in den größeren Durchmesser des Kegels zu garantieren.

## 16

## DIN 69893-HSK-A

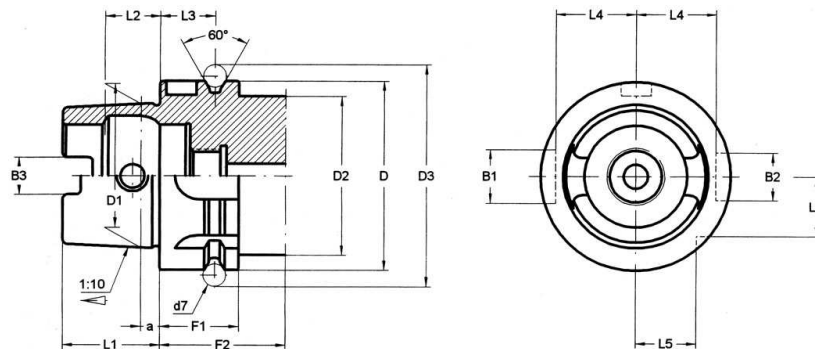

HSK	Dh10 mm	D1 mm	D2 max mm	D3 <sub>-0,1</sub> mm	B1 H10 mm	B2 H10 mm	B3±0,4 mm	d7 mm
32	32	24	26	37,0	9	7	7,05	4
40	40	30	34	45,0	11	9	8,05	4
50	50	38	42	59,3	14	12	10,54	7
63	63	48	53	72,3	18	16	12,54	7
80	80	60	67	88,8	20	18	16,04	7
100	100	75	85	109,75	22	20	20,02	7

HSK	L1 <sub>-0,2</sub> mm	L2 JS10 mm	L3±0,1 mm	L4 <sub>-0,2</sub> mm	L5 <sub>-0,3</sub> mm	F1 <sub>-0,1</sub> mm	F2 min mm	a mm
32	16	8,92	16	13,0	9,5	20	35	3,2
40	20	11,42	16	17,0	12,0	20	35	4,0
50	25	14,13	18	21,0	15,5	26	42	5,0
63	32	18,13	18	26,5	20,0	26	42	3,3
80	40	22,85	18	34,0	25,0	26	42	8,0
100	50	28,56	20	44,0	31,5	29	45	10,0

<b>16.160</b>  C.02	<b>16.180</b>  C.03	<b>16.210</b>  C.04	<b>16.215</b>  C.05	<b>16.296</b>  C.06
<b>16.300</b>  C.07	<b>16.305</b>  C.08	<b>16.315</b>  C.09	<b>16.453</b>  C.10	<b>16.455</b>  C.11
<b>16.470</b>  C.12	<b>16.999</b>  C.12			

16  
HSK DIN 69893-1

17  
TS ISO 26622-1

18  
PSC ISO 26623-1

20 23  
JIS B 6339-BT

25  
CHIRON

BORING HEADS  
BOHRKÖPFE

MORSE SHANKS  
MORSE SCHÄFTE

CYLINDRICAL SHANKS  
ZYLINDRISCHE SCHÄFTE

ACCESSORIES  
ZUBEHÖR

DIN 69893-1 / HSK Form-A

**16.160****SHELL MILL ADAPTORS**



for cutters with driving slot DIN 138

**AUFSTECKFRÄSDORNE**

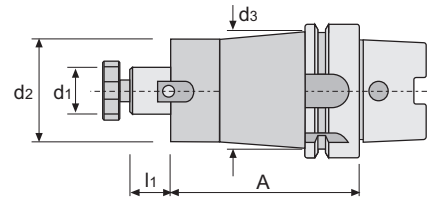
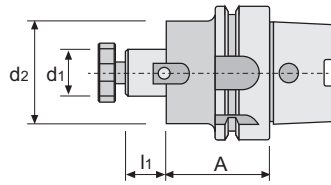
für Fräser mit Quernut DIN 138



REF.	HSK	d <sub>1</sub> mm	d <sub>2</sub> mm	A mm	l <sub>1</sub> mm	d <sub>3</sub> mm	
16.160.050.16	50	16	38	50	17	-	-
16.160.050.22		22	48	50	19	-	-
16.160.050.27		27	58	60	21	-	-
16.160.063.16	63	16	38	50	17	-	-
16.160.063.16/100		16	38	100	17	46	-
16.160.063.16/160		16	38	160	17	46	-
16.160.063.22		22	47	50	19	-	-
16.160.063.22/100		22	47	100	19	53	-
16.160.063.22/160		22	48	160	19	53	-
16.160.063.27		27	58	60	21	-	-
16.160.063.27/100		27	58	100	21	-	-
16.160.063.27/160		27	58	160	21	-	-
16.160.063.32		32	64	60	24	-	-
16.160.063.32/100		32	64	100	24	-	-
16.160.063.32/160		32	64	160	24	-	-
16.160.063.40		40	80	60	27	-	-
16.160.063.40/100		40	80	100	27	-	-
16.160.100.16	100	16	38	50	17	-	-
16.160.100.22		22	48	50	19	-	-
16.160.100.27		27	55	50	21	-	-
16.160.100.32		32	64	50	24	-	-
16.160.100.40		40	80	60	27	-	-
16.160.100.40		40	80	100	27	-	-



REF.			
16.160.050.16	10008	86016	11103
16.160.050.22	10010	86022	11004
16.160.050.27	10012	86027	11005
16.160.063.16	10008	86016	11103
16.160.063.16/100	10008	86016	11103
16.160.063.16/160	10008	86016	11103
16.160.063.22	10010	86022	11004
16.160.063.22/100	10010	86022	11004
16.160.063.22/160	10010	86022	11004
16.160.063.27	10012	86027	11005
16.160.063.27/100	10012	86027	11005
16.160.063.27/160	10012	86027	11005
16.160.063.32	10016	86032	11105
16.160.063.32/100	10016	86032	11105
16.160.063.32/160	10016	86032	11105
16.160.063.40	10020	86040	11006
16.160.063.40/100	10020	86040	11006
16.160.100.16	10008	86016	11103
16.160.100.22	10010	86022	11004
16.160.100.27	10012	86027	11005
16.160.100.32	10016	86032	11105
16.160.100.40	10020	86040	11006

DIN 69893-1  
DIN 6358 - Form B  
**16.180**

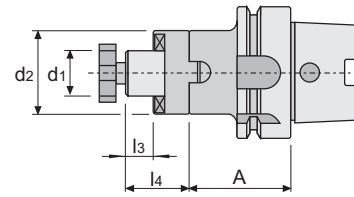
**COMBI-SHELL MILL ADAPTOR**  
for cutters with keyway or driving slot DIN 138  
**KOMBI-AUFSTECKFRÄSDORNE**  
für Fräser mit Längsnut oder Stirnmitnehmer DIN 138



REF.	HSK	d <sub>1</sub> h6 mm	A mm	l <sub>3</sub> mm	l <sub>4</sub> mm	d <sub>2</sub> mm	⚖ kg
16.180.063.16	63	16	55	17	27	32	-
16.180.063.16/100		16	100	17	27	32	-
16.180.063.22		22	55	19	31	40	-
16.180.063.22/100		22	100	19	31	40	-
16.180.063.27		27	55	21	33	48	-
16.180.063.27/100		27	100	21	33	48	-
16.180.063.32		32	60	24	38	58	-
16.180.063.32/100		32	100	24	38	58	-
16.180.063.40		40	60	27	41	70	2,110
16.180.063.40/100		40	100	27	41	70	-
16.180.100.16	100	16	55	17	27	32	-
16.180.100.16/100		16	100	17	27	32	-
16.180.100.22		22	55	19	31	40	2,500
16.180.100.22/100		22	100	19	31	40	-
16.180.100.27		27	55	21	33	48	-
16.180.100.27/100		27	100	21	33	48	-
16.180.100.32		32	60	24	38	58	-
16.180.100.32/100		32	100	24	38	58	-
16.180.100.40		40	60	27	41	70	-
16.180.100.40/100		40	100	27	41	70	-

REF.			
16.180.063.16	10008	60116	88016
16.180.063.16/100	10008	60116	88016
16.180.063.22	10010	60122	88022
16.180.063.22/100	10010	60122	88022
16.180.063.27	10012	60127	88027
16.180.063.27/100	10012	60127	88027
16.180.063.32	10016	60132	88032
16.180.063.32/100	10016	60132	88032
16.180.063.40	10020	60140	88040
16.180.063.40/100	10020	60140	88040
16.180.100.16	10008	60116	88016
16.180.100.16/100	10008	60116	88016
16.180.100.22	10010	60122	88022
16.180.100.22/100	10010	60122	88022
16.180.100.27	10012	60127	88027
16.180.100.27/100	10012	60127	88027
16.180.100.32	10016	60132	88032
16.180.100.32/100	10016	60132	88032
16.180.100.40	10020	60140	88040
16.180.100.40/100	10020	60140	88040

DIN 69893-1

**16.210****REDUCING ADAPTORS**



for tools with Morse taper shank and drawbar thread DIN 228-A

**REDUZIERHÜLSEN**

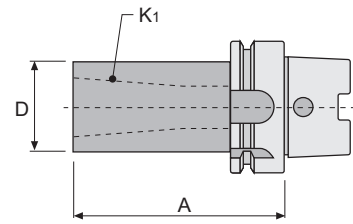
für Werkzeuge mit Morsekegel und Anzugsgewinde DIN 228-A



REF.	HSK	K1 MORSE	A mm	D mm	kg
16.210.050.01	50	1	100	25	-
16.210.050.02		2	120	32	-
16.210.050.03		3	140	40	-
16.210.063.01	63	1	100	25	-
16.210.063.02		2	120	32	-
16.210.063.03		3	140	40	-
16.210.063.04		4	160	48	-
16.210.100.02	100	2	120	32	-
16.210.100.03		3	150	40	-
16.210.100.04		4	170	48	-
16.210.100.05		5	200	63	-

REF.			
16.210.050.01	16205	19624	18006
16.210.050.02	16205	19324	18110
16.210.050.03	16205	19524	18112
16.210.063.01	16205	19624	18006
16.210.063.02	16205	19324	18110
16.210.063.03	16205	19524	18112
16.210.063.04	16205	19424	18016
16.210.100.02	16205	19324	18110
16.210.100.03	16205	19524	18112
16.210.100.04	16205	19424	18016
16.210.100.05	16205	19338	18020

DIN 69893-1  
**16.215**

**REDUCING ADAPTORS**

for tools with Morse taper and tang DIN 228-B shank or drawbar

**REDUZIERHÜLSEN**

für Werkzeuge mit Morsekegel und Austreibblappen oder Anzugsgewinde DIN 228-B

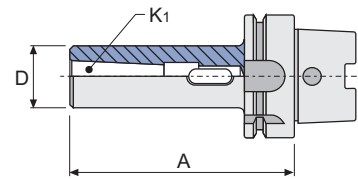

REF.	HSK	K <sub>1</sub> MORSE	A mm	D mm	 kg
16.215.050.01	50	1	100	25	-
16.215.050.02		2	120	32	-
16.215.050.03		3	140	40	-
16.215.063.01	63	1	100	25	-
16.215.063.02		2	120	32	-
16.215.063.03		3	140	40	-
16.215.063.04		4	160	48	-
16.215.100.02	100	2	120	32	-
16.215.100.03		3	150	40	-
16.215.100.04		4	170	48	-
16.215.100.05		5	200	63	-

16  
 HSK DIN 69893-1

17  
 TS ISO 26622-1

18  
 PSC ISO 26623-1

20 23  
 JIS B 6339-BT

25  
 CHIRON

BORING HEADS  
 BOHRKÖPFE

MORSE SHANKS  
 MORSE SCHÄFTE

CYLINDRICAL SHANKS  
 ZYLINDRISCHE SCHÄFTE

ACCESSORIES  
 ZUBEHÖR

DIN 69893-1

**16.296****CNC-UNIVERSAL PRECISION DRILL CHUCKS**

for left and right hands turn and internal coolant

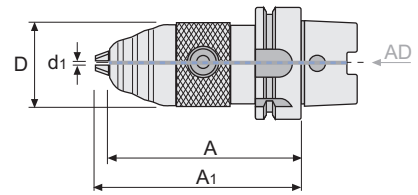

**UNIVERSALER CNC-BOHRFUTTER, GENAUIGKEITSAUSFÜHRUNG**

für links- und rechtslaufende Bearbeitungen, mit Innenkühlung



REF.	HSK	d <sub>1</sub> mm	D mm	A mm	A <sub>1</sub> max mm	
16.296.050.13	50	1-13	50	86,4	93,4	-
16.296.050.16		3-16	56	96,4	103,4	-
16.296.063.13	63	1-13	50	89,4	96,4	-
16.296.063.16		3-16	56	96,4	103,4	-
16.296.100.13	100	1-13	50	100,4	107,4	-
16.296.100.16		3-16	56	107,4	114,4	-

\* SUPPLIED WITH WRENCH / \* GELIEFERT MIT SCHLÜSSEL

REF.		3 x 
16.296.050.13	50706	60313
16.296.050.16	50706	60313
16.296.063.13	50706	60313
16.296.063.16	50706	60313
16.296.100.13	50706	60313
16.296.100.16	50706	60313

DIN 69893-1  
**16.300**



**WELDON END MILL ADAPTORS**

for cutters with cylindrical shank and weldon flat DIN 1835-B

**ZYLINDERSCHAFT-AUFNAHME WELDON**

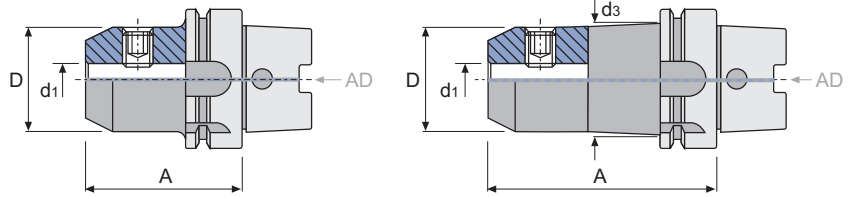
für Fräser mit zylindrischem Schaft und Weldon-Fläche DIN 1835-B



REF.	HSK	d <sub>1</sub> mm	A mm	D mm	d <sub>3</sub> mm		
16.300.050.06	50	6	65	25	-	15106	-
16.300.050.08		8	65	28	-	15108	-
16.300.050.10		10	65	35	-	15110	-
16.300.050.12		12	80	42	-	15212	-
16.300.050.14		14	80	44	-	15212	-
16.300.050.16		16	80	48	-	15314	-
16.300.050.18		18	80	50	-	15314	-
16.300.050.20		20	80	52	-	15216	-
16.300.063.06	63	6	65	25	-	15106	-
16.300.063.06/160		6	160	25	30	15106	-
16.300.063.08		8	65	28	-	15108	-
16.300.063.08/160		8	160	28	32	15108	-
16.300.063.10		10	65	35	-	15110	-
16.300.063.10/160		10	160	35	32	15110	-
16.300.063.12		12	80	42	-	15212	-
16.300.063.12/160		12	160	42	45	15212	-
16.300.063.14		14	80	44	-	15212	-
16.300.063.14/160		14	160	44	48	15212	-
16.300.063.16		16	80	48	-	15314	-
16.300.063.16/160		16	160	48	52	15314	-
16.300.063.18		18	80	50	-	15314	-
16.300.063.18/160		18	160	50	52	15314	-
16.300.063.20		20	80	52	-	15216	-
16.300.063.20/160		20	160	52	-	15216	-
16.300.063.25		25	110	65	-	2 x 15218	2,310
16.300.063.25/160		25	160	65	-	2 x 15218	-
16.300.063.32	32	110	72	-	2 x 15220	-	
16.300.063.32/160	32	160	72	-	2 x 15220	-	
16.300.100.06	100	6	80	25	-	15106	-
16.300.100.06/160		6	160	25	30	15106	-
16.300.100.08		8	80	28	-	15108	-
16.300.100.08/160		8	160	28	32	15108	-
16.300.100.10		10	80	35	-	15110	-
16.300.100.10/160		10	160	35	32	15110	-
16.300.100.12		12	80	42	-	15212	-
16.300.100.12/160		12	160	42	45	15212	-
16.300.100.14		14	80	44	-	15212	-
16.300.100.14/160		14	160	44	48	15212	-
16.300.100.16		16	100	48	-	15314	-
16.300.100.16/160		16	160	48	52	15314	-
16.300.100.18		18	100	50	-	15314	-
16.300.100.18/160		18	160	50	52	15314	-
16.300.100.20		20	100	52	-	15216	-
16.300.100.20/160		20	160	52	-	15216	-
16.300.100.25		25	100	65	-	2 x 15218	-
16.300.100.25/160		25	160	65	-	2 x 15218	-
16.300.100.32		32	100	72	-	2 x 15220	-
16.300.100.32/160		32	160	72	-	2 x 15220	-
16.300.100.40	40	100	80	-	2 x 15024	-	
16.300.100.40/160	40	160	80	-	2 x 15024	-	

ACCESSORIES / ZUBEHÖR 42.300 - 42.311: For more information see page / Für weitere Informationen siehe Seite: J.11, J.12



DIN 69893-1



**16.305****END MILL ADAPTORS TYPE WHISTLE-NOTCH**

for tools with cylindrical shank and tightening inclined flat DIN 1835-E

**ZYLINDERSCHAFT-AUFNAHME TYP WHISTLE-NOTCH**

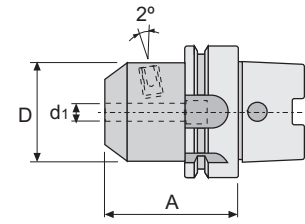
für Werkzeuge mit zylindrischem Schaft und geneigte Spannfläche DIN 1835-E



REF.	HSK	d <sub>1</sub> H4 mm	A mm	D mm			
16.305.050.06	50	6	80	25	19005	15106	-
16.305.050.08		8	80	28	19106	15108	-
16.305.050.10		10	80	35	19008	15110	-
16.305.050.12		12	90	42	19110	15212	-
16.305.050.14		14	90	44	19110	15212	-
16.305.050.16		16	100	48	19012	15314	-
16.305.050.18		18	100	50	19012	15314	-
16.305.050.20		20	100	52	19016	15216	-
16.305.063.06	63	6	80	25	19005	15106	-
16.305.063.08		8	80	28	19106	15108	-
16.305.063.10		10	80	35	19008	15110	-
16.305.063.12		12	90	42	19110	15212	-
16.305.063.14		14	90	44	19110	15212	-
16.305.063.16		16	100	48	19012	15314	-
16.305.063.18		18	100	50	19012	15314	-
16.305.063.20		20	100	52	19016	15216	-
16.305.063.25		25	110	65	19020	15218	-
16.305.063.32		32	115	72	19020	15220	-
16.305.100.06	100	6	90	25	19005	15106	-
16.305.100.08		8	90	28	19106	15108	-
16.305.100.10		10	90	35	19008	15110	-
16.305.100.12		12	100	42	19110	15212	-
16.305.100.14		14	100	44	19110	15212	-
16.305.100.16		16	100	48	19012	15314	-
16.305.100.18		18	100	50	19012	15314	-
16.305.100.20		20	100	52	19016	15216	-
16.305.100.25		25	120	65	19020	15218	-
16.305.100.32		32	120	72	19020	15220	-
16.305.100.40		40	130	80	19020	15220	-

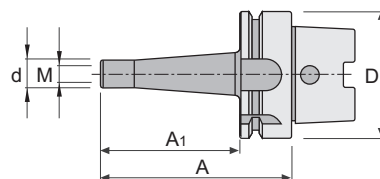

REF.	HSK	d mm	M mm	A mm	A <sub>1</sub> mm	D mm	⚖ kg
16.315.063.10/050	63	18	10	50	24	63	-
16.315.063.10/100		18	10	100	74	63	-
16.315.063.12/050		21	12	50	24	63	-
16.315.063.12/100		21	12	100	74	63	-
16.315.063.16/050		29	16	50	24	63	-
16.315.063.16/100		29	16	100	74	63	-
16.315.100.10/100	100	18	10	100	71	100	-
16.315.100.10/150		18	10	150	121	100	-
16.315.100.12/100		21	12	100	71	100	-
16.315.100.12/150		21	12	150	121	100	-
16.315.100.16/100		29	16	100	71	100	-
16.315.100.16/150		29	16	150	121	100	-

REF.	ACCESSORIES / ZUBEHÖR
06.315	Front contact extensions for modular tools. / Stirnverlängerung für Einschraubfräser.
06.315	Front contact reducers for modular tools. / Stirnreduzierhülsen für Einschraubfräser.

06.315

06.315

For more information see page / Für weitere Informationen siehe Seite: J.02, J.03

16  
HSK DIN 69893-1

17  
TS ISO 26622-1

18  
PSC ISO 26623-1

20 23  
JIS B 6339-BT

25  
CHIRON

BORING HEADS  
BOHRKÖPFE

MORSE SHANKS  
MORSE SCHÄFTE

CYLINDRICAL SHANKS  
ZYLINDRISCHE SCHÄFTE

ACCESSORIES  
ZUBEHÖR

DIN 69893-1 / HSK Form A





**16.453****COLLET CHUCKS FOR DIN 6499 (ER) COLLETS**

for tools with cylindrical shank

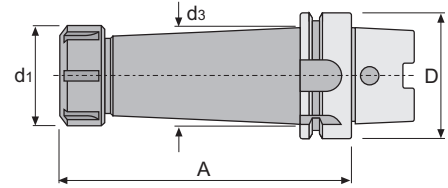
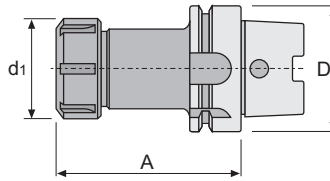
**SPANNZANGENFUTTER FÜR SPANNZANGEN 6499 (ER)**

für Werkzeuge mit zylindrischem Schaft



REF.	HSK		A mm	d <sub>1</sub> mm	D mm	d <sub>3</sub> mm			
16.453.050.16	50	ER16	100	0,5-10	32	-	45316	50216	-
16.453.050.20		ER20	100	1-13	35	-	45320	50220	-
16.453.050.25		ER25	100	1-16	42	-	45325	50225	-
16.453.050.25/160		ER25	160	1-16	42	42	45325	50225	-
16.453.050.32		ER32	100	2-20	50	-	45332	50232	-
16.453.050.32/160		ER32	160	2-20	50	42	45332	50232	-
16.453.050.40		ER40	100	3-30	63	-	45340	50240	-
16.453.063.16	63	ER16	100	0,5-10	32	-	45316	50216	-
16.453.063.16/160		ER16	160	0,5-10	32	32	45316	50216	-
16.453.063.20		ER20	100	1-13	35	-	45320	50220	-
16.453.063.20/160		ER20	160	1-13	35	35	45320	50220	-
16.453.063.25		ER25	100	1-16	42	-	45325	50225	-
16.453.063.25/160		ER25	160	1-16	42	42	45325	50225	1,840
16.453.063.32		ER32	100	2-20	50	-	45332	50232	1,470
16.453.063.32/160	ER32	160	2-20	50	50	45332	50232	-	
16.453.063.40	ER40	100	3-30	63	-	45340	50240	-	
16.453.063.40/160	ER40	160	3-30	63	-	45340	50240	-	
16.453.100.16	100	ER16	100	0,5-10	32	-	45316	50216	-
16.453.100.20		ER20	100	1-13	35	-	45320	50220	-
16.453.100.25		ER25	100	1-16	42	-	45325	50225	-
16.453.100.25/160		ER25	160	1-16	42	42	45325	50225	-
16.453.100.32		ER32	100	2-20	50	-	45332	50232	-
16.453.100.32/160		ER32	160	2-20	50	50	45332	50232	-
16.453.100.40		ER40	100	3-30	63	-	45340	50240	-
16.453.100.40/160	ER40	160	3-30	63	63	45340	50240	-	

\* If you want with ball bearing nut, see page: K.22

\* Wenn Sie diese mit Kugellager-Nute möchten, siehe Seite: K.22

\* SUPPLIED WITHOUT WRENCH / \* GELIEFERT OHNE SCHLÜSSEL

REF.	ACCESSORIES / ZUBEHÖR
ERXX	Collets double slot DIN 6499 - Form B (ER) / Spannzangen mit Doppelnut DIN 6499 - Form B (ER)
ERCXX	Sealed collets DIN 6499 (ER) / Abgedichtete Spannzangen DIN 6499 (ER)
ERTXX	Collets DIN 6499 - Form Canela (ER) / Spannzangen DIN 6499 - Form Canela (ER)
40.453..	Collet chucks for DIN 6499 (ER) collets / Spannzangenfutter für DIN 6499 (ER) Spannzangen
40.455..	Long collet chucks for DIN 6499 (ER) collets / Lange Spannzangenfutter für DIN 6499 (ER) Spannzangen



ERXX



ERCXX



ERTXX



40.453..





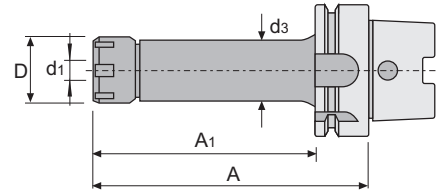

40.455..

For more information see page / Für weitere Informationen siehe Seite: K.13, K.17, K.19, J.08, J.09

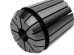
WITH "MINI" COLLET NUT  
MIT "MINI"-SPANNMUTTER



REF.	HSK		d <sub>1</sub> mm	A mm	D mm	A <sub>1</sub> mm	d <sub>3</sub> mm				
16.455.063.16	63	ER16	0,5-10	100	22	-	-	45516	50916	19210	-
16.455.063.16/160		ER16	0,5-10	160	22	100	30	45516	50916	19210	-
16.455.063.20		ER20	1-13	100	28	-	-	45520	50920	19212	-
16.455.063.20/160		ER20	1-13	160	28	100	30	45520	50920	19212	-
16.455.063.25		ER25	1-16	100	35	-	-	45525	50925	19216	-
16.455.063.25/160		ER25	1-16	160	35	100	30	45525	50925	19216	-

\* SUPPLIED WITHOUT WRENCH / \* GELIEFERT OHNE SCHLÜSSEL

REF.	ACCESSORIES / ZUBEHÖR
ERXX	Collets double slot DIN 6499 - Form B (ER) / Spannzangen mit Doppelnut DIN 6499 - Form B (ER)
ERCXX	Sealed collets DIN 6499 (ER) / Abgedichtete Spannzangen DIN 6499 (ER)
ERTXX	Collets DIN 6499 - Form Canela (ER) / Spannzangen DIN 6499 - Form Canela (ER)



ERXX



ERCXX



ERTXX

For more information see page / Für weitere Informationen siehe Seite: K.13, K.17, K.19

DIN 69893-1 / HSK Form A

16.470

BLANK ADAPTORS

ROHLINGE MIT WEICHEM SCHAFT

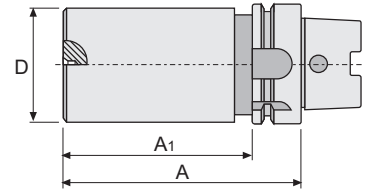

REF.	HSK	D mm	A <sub>1</sub> mm	A mm	kg
16.470.050.50/200	50	50	174	200	-
16.470.050.63/200		63	174	200	-
16.470.063.63/100	63	63	74	100	-
16.470.063.63/200		63	174	200	-
16.470.063.80/250		80	224	250	-
16.470.100.63/200	100	63	171	200	-
16.470.100.80/250		80	221	250	-
16.470.100.85/045		85	16	45	-
16.470.100.90/300		90	271	300	-

\* SUPPLIED WITHOUT WRENCH / \* GELIEFERT OHNE SCHLÜSSEL

DIN 69893-1

16.999

CONTROL PINS

PRÜFDORNE

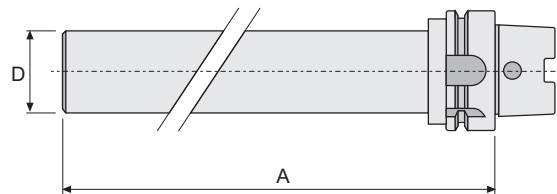

REF.	HSK	A	D	kg
16.999.050	50	300	40	-
16.999.063	63	300	40	-
16.999.100	100	300	50	-

**1** TYPE / TYP

16.160 	16.180 	16.210 	16.215 
16.296 	16.300 	16.305 	16.315 
16.453 	16.455 	16.470 	

**2** DIMENSION / ABMESSUNG

<b>32</b>	<b>40</b>	<b>50</b>	<b>63</b>	<b>80</b>	<b>100</b>
-----------	-----------	-----------	-----------	-----------	------------

**3** LENGTH (A) / LÄNGE (A)



---

---

---

---

---

---

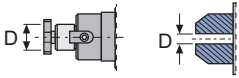
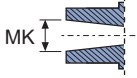
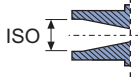
DIAMETER / DURCHMESSER	MK	ISO	COLLET SPANNZANGE
			

NOTES: \_\_\_\_\_

\_\_\_\_\_

\_\_\_\_\_

\_\_\_\_\_

\_\_\_\_\_

16  
HSK DIN 69893-1

17  
TS ISO 26622-1

18  
PSC ISO 26623-1

20 23  
JIS B 6339-BT

25  
CHIRON

BORING HEADS  
BOHRKÖPFE

MORSE SHANKS  
MORSE SCHÄFTE

CYLINDRICAL SHANKS  
ZYLINDRISCHE SCHÄFTE

ACCESSORIES  
ZUBEHÖR